



JOB NAME:

CAT#:

TYPE:

APPLICATIONS

Give your area a new clean and sleek look with this designer series retrofit solution. This fixture is sure to enhance any environment. Designed to convert your old 4' or 8' T12 or T8 linear strips or industrial fixtures with New LED Technology.

Choose between 3 aesthetic options: flat lens, dome lens or rounded lens, all provide energy savings and better quality lighting. These flexible options are cost effective and make this a perfect retrofit for : Schools, retail, warehouse, storage or any other facility area currently using strip fixtures. All the kit styles adapt easily to your existing backbox for quick retrofit.



RKBCF - (Flat Lens)

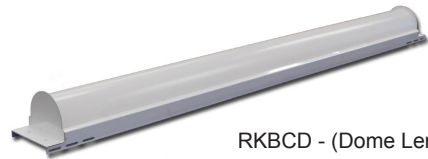

RKBCD - (Dome Lens)

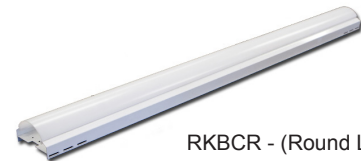

RKBCR - (Round Lens)

FEATURES & BENEFITS

- Flat Lens, Dome Lens or Rounded Lens
- Size: 4FT: 4.25"W x 48"L
8FT: 4.25"W x 96"L

DIMENSIONS

Side View

RKBCF

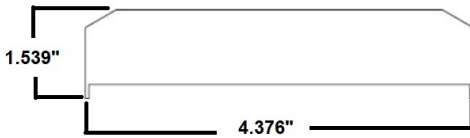

RKBCD

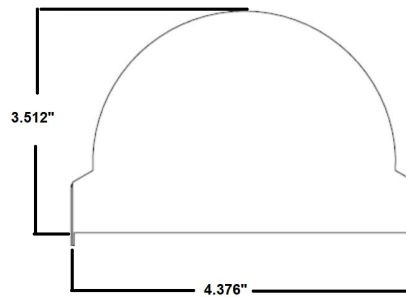

RKBCR

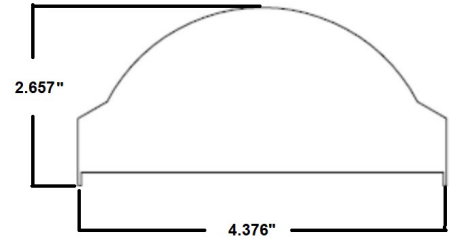

NOTE: Values shown are typical or recorded under standardized conditions at 25°C. Actual performance may vary based on environment or application. Specifications are subject to change without notice. We reserve the right to change design, materials, LED's and finish in any way that will not alter installed appearance or reduce function and performance.





JOB NAME:

CAT#:

TYPE:

ORDERING

EXAMPLE: RKBCF 48 LED 20 DMV 30

LED

1. SERIES	2. LENGTH	3. WIDTH	4. GEAR	4. WATTAGE/LUMENS	5. DRIVER	6. COLOR TEMP
RKBCF LED Retrofit Strip Flat Lens	48 48"	Blank 4.25"	LED	4 ft.	DMV 120-277VAC 0-10V Dimming	30 3000K 40 4000K
RKBCD LED Retrofit Strip Dome Lens	96 96"	*Consult for other options		20 20 Watts 2700 Lumens 30 30 Watts 3500 Lumens 41 41 Watts 4300 Lumens 58 58 Watts 6700 Lumens	SDMV Step Dimming 120-277VAC 100%-40%	
RKBCR LED Retrofit Strip Round Lens				8 ft. 40 40 Watts 4700 Lumens 60 60 Watts 6900 Lumens 82 82 Watts 8900 Lumens 116 134 Watts 13400 Lumens		

NOTE: Values shown are typical or recorded under standardized conditions at 25°C. Actual performance may vary based on environment or application. Specifications are subject to change without notice. We reserve the right to change design, materials, LED's and finish in any way that will not alter installed appearance or reduce function and performance.

