

### APPLICATIONS

Premium quality low profile troffer with an almost limitless range of applications. Ideal for all commercial and industrial buildings requiring general illumination with recessed configurations.

### FEATURES & BENEFITS

- ◆ Min CRI 80
- ◆ L70 >60,000 hrs
- ◆ Corrosion and scratch resistant
- ◆ Smooth edges for easy handling
- ◆ Ends are secured by snap-in interlocking system
- ◆ .100 acrylic prismatic lens is standard
- ◆ Exclusive "Light Lock" frame reduces light leaks
- ◆ Flush steel door with rotary action cam latches and hinges from either side
- ◆ Easy access plate for quick wiring
- ◆ Equipped with Integral Earthquake Clips
- ◆ **ETL** listed for damp location
- ◆ DLC listed in certain models - consult DLC QPL for verification



### SPECIFICATIONS

Housing is die-formed and embossed from cold rolled steel. Wiring access plate and knockouts are provided on back of housing allowing for flexible greenfield attachment. Driver cover snaps easily into place eliminating the need for tools when accessing the driver. Prismatic lens is held within a hinged steel frame door. The heavy gauge door frame hinges downward on either side and is held in the closed position by two positive cam latches. Knockouts are provided on ends for continuous wiring.

### ORDERING DATA

EXAMPLE: RG22-LED35DMV40

RG		Series		Size		Gear		Wattage & Lumens		Driver Type <sup>1</sup>		Color Temp	
		<b>RG</b>	<b>14</b>	1x4		<b>LED</b>		<b>Standard 1x4</b>	<b>DMV</b>	120-277VAC	<b>30</b>	3000K	
		LED Grid	<b>22</b>	2x2				22 Watts 2810 Lumens		0-10V Dimming	<b>35</b>	3500K	
			<b>24</b>	2x4				30 Watts 3585 Lumens	<b>SDMV</b>	Step dimming	<b>40</b>	4000K	
								35 Watts 4090 Lumens		Multivolt	<b>50</b>	5000K	
								40 Watts 4590 Lumens					
								48 Watts 5385 Lumens					
								57 Watts 6370 Lumens					
								<b>Standard 2x2</b>					
								20 Watts 2300 Lumens					
								24 Watts 2600 Lumens					
								28 Watts 3000 Lumens					
								35 Watts 3600 Lumens					
								45 Watts 4470 Lumens					
								<b>Standard 2x4</b>					
								32 Watts 3970 Lumens					
								35 Watts 4345 Lumens					
								45 Watts 5500 Lumens					
								48 Watts 5900 Lumens					
								57 Watts 6735 Lumens					
								62 Watts 7000 Lumens					
								72 Watts 8700 Lumens					

DLC Listed	
RG14-LED22DMVxx	xx=30,35,40,50
RG14-LED30DMVxx	xx=30,35,40,50
RG14-LED35DMVxx	xx=30,35,40,50
RG14-LED40DMVxx	xx=30,35,40,50
RG14-LED48DMVxx	xx=30,35,40,50
RG14-LED57DMVxx	xx=30,35,40,50
RG22-LED20DMVxx	xx=30,35,40,50
RG22-LED24DMVxx	xx=30,35,40,50
RG22-LED28DMVxx	xx=30,35,40,50
RG22-LED35DMVxx	xx=30,35,40,50
RG22-LED45DMVxx	xx=30, 35,40,50
RG24-LED35DMVxx	xx=30,35,40,50
RG24-LED45DMVxx	xx=30,35,40,50
RG24-LED48DMVxx	xx=30,35,40,50
RG24-LED57DMVxx	xx=30,35,40,50

Options	
<b>EM</b>	10W, 1300 lumen, battery backup
<b>EM5</b>	5W, 650 lumen, battery backup
<b>EM7</b>	7W, 900 lumen, battery backup
<b>EM12K</b>	1200 Board Lume LED Emergency Kit
<b>Blank</b>	A12 .100 thick lens
<b>125</b>	A12 .125 thick lens
<b>156</b>	A19 .156 thick lens
<b>CL</b>	Clear .100 thick lens
<b>CL125</b>	Clear .125 thick lens
<b>SSM</b>	Microwave Sensor
<b>SW</b>	Smooth White .100 thick lens
<b>S5</b>	Specular Parabolic Louver (1/2"x1/2"x3/8")
<b>S75</b>	Specular Parabolic Louver (3/4"x3/4"x3/8")
<b>S15</b>	Specular Parabolic Louver (1 1/2"x1 1/2"x1")
<b>W5</b>	White Parabolic Louver (1/2"x1/2"x3/8")
<b>NL</b>	No Lens
<b>NFL</b>	No Frame and Lens
<b>FR</b>	High Optic Frosted
<b>G3</b>	Triple Gasketing
<b>FA</b>	Flush Aluminum
<b>WP</b>	6FT 3 wire whip

\*Consult for other wattages  
Consult factory for Triac Dimming Options.

Dimensions and specifications subject to change without notice.

◆ 800-444-WATT ◆ www.mobern.com ◆

8200 Stayton Dr., Ste. 500, Jessup, MD 20794

CAT#	
JOB NAME	
TYPE	



### DIMENSIONS

#### TOP VIEWS

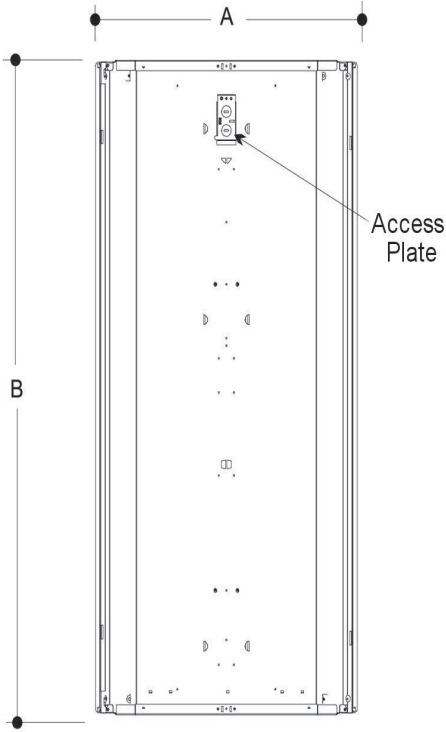

#### MODEL CONFIGURATION

A

1' x 4'	12"	47 7/8"
2' x 2'	23 3/4"	23 3/4"
2' x 4'	23 3/4"	47 3/4"

#### SIDE VIEW

B

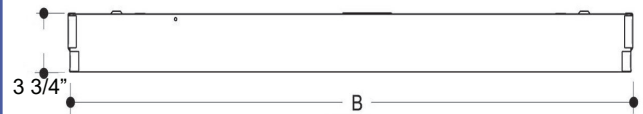

#### END VIEW

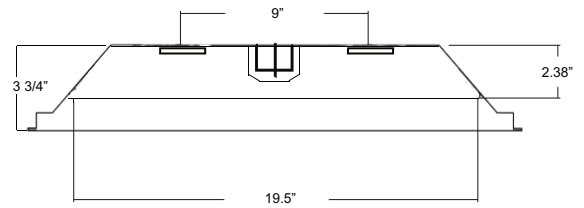

Dimensions and specifications subject to change without notice.



◆ 800-444-WATT ◆ [www.mobern.com](http://www.mobern.com) ◆

8200 Stayton Dr., Ste. 500, Jessup, MD 20794

CAT#

JOB NAME

TYPE