

### APPLICATIONS

Designed especially for LED, this new LED series provides beautiful glare free lighting from LED arrays. Downlight is shielded with a sleek, rounded frosted ribbed lens. Optional up-light utilizes its own LED array that can be separately switched and is lensed for applications that can be seen from above. Configure for individual lengths in four and eight foot or joined together easily for continuous runs. Pendant mount with adjustable cable kit and available in a variety of off the shelf finishes or custom finishes.

### FEATURES & BENEFITS

#### SIZE W x L x H in inches (mm)

4ft. - 10.8" x 47" x 3.94"

8ft. - 10.8" x 94" x 3.94"

#### MOUNTING

Standard 4' adjustable power cable (2 for 4' unit or 8' unit, included).

#### CONSTRUCTION

Rugged steel housing with anti-rust protection powder coated white. Custom paint finishes available.

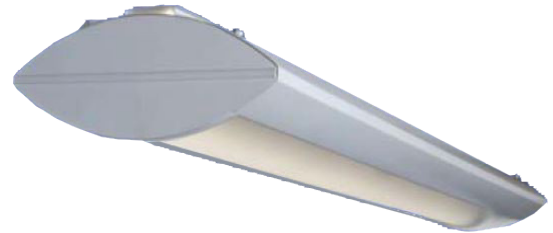

### TYPICAL OPTIONS AND ACCESSORIES

Emergency driver, occupancy sensors, hanging kits, factory installed dimming, standard and custom colors. Contact factory for additional options.

### LISTING

Fixtures conform to Underwriters' Laboratories standards for production and are carefully tested prior to packing. cETLus Listed for damp locations.

### ORDERING DATA

### EXAMPLE: LPLIA48LED1U2D60FIDMVWH40

LPLIA		LED		Lens		Driver Type		Housing Color		Color Temp	
Series	Size	Gear									
LPLIA	48 4' Nominal	LED		blank	Frosted Lens Down No uplight lens	DMV	120-277VAC 0-10V	WH	White	30	3000K
LED Wide Area Linear Direct/Indirect	96 8' Nominal			UL	Uplight Lens (Uplight Options Only)	FIDMV	120-277VAC w/Factory wired 0-10V dimming	SL	Metallic Silver	35	3500K
								RD	Red	40	4000K
								IN	Iron	50	5000K
								BK	Black		

\*Consult for Triac and Step Dimming Options

Configuration	
Blank	Individual
-B	Beginnner Run
-E	Ender Run
-J	Joiner

Options	
EM	10W Emergency Backup ~1300 Fixture Lumens
EM7	7W Emergency Backup ~900 Fixture Lumens
EM5	5W Emergency Backup ~650 Fixture Lumens
C12	12 Ft. adjustable hanging & power cables
	Consult for uplight options

Total Wattage/Total Lumens	
<u>48-4' or 96 8' Nominal</u>	
24	24 Watts 3025 Lumens
35	35 Watts 4505 Lumens
48	48 Watts 5925 Lumens
60	60 Watts 6900 Lumens
90	90 Watts 10820 Lumens*
<u>96 - 8' Nominal</u>	
48	48 Watts 6050 Lumens
70	70 Watts 9010 Lumens
96	96 Watts 11850 Lumens
120	120 Watts 13800 Lumens
180	180 Watts 21640 Lumens*
	(Up/Down Only)

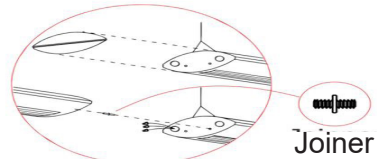

Joiner

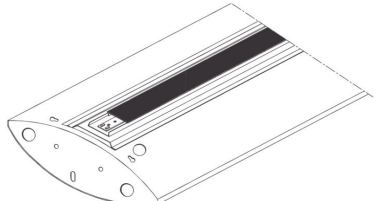

Optional Up-Light

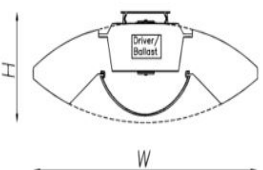

Dimensions and specifications subject to change without notice.

Plug in System Options: it's for continuous run applications by simply plugging in sections together

Part #	Description
P11	3 wire harness, including white, black and green
P12	4 wire harness, including white, black, green and blue for emergency battery backup
P13D	5 wire harness, including white, black, green, violet and gray

♦ 800-444-WATT ♦ www.mobern.com ♦ CAT# \_\_\_\_\_  
 8200 Stayton Dr., Ste. 500, Jessup, MD 20794 JOB NAME \_\_\_\_\_ TYPE \_\_\_\_\_