

### APPLICATIONS

High efficiency LED engineered for premium performance in medium and high ceiling applications ideally suited for warehouses, manufacturing plants, sports facilities and retail spaces. A precision-formed reflector system available in highly reflective enhanced white reflector achieve maximum light output for ceilings from 15 feet to 40 feet. The unique arrangement is ideal for wide area lighting to put the light exactly where you need it with less fixtures. Based on ceiling height, these fixtures can replace an HID high bay using half of the wattage. Surface, pendant, chain or stem mounting. Highest quality materials and workmanship.

#### SIZE: W x L x H in inches

24L: 15.575W x 23.379"L x 4.296"H

48L: 15.575W x 45.160"L x 4.296"H

### FEATURES & BENEFITS

- ◆ Designed for surface, pendant, stem or chain hanging
- ◆ Mounting holes provided for simple, fast installation
- ◆ ETL<sub>us</sub> Listed

### APPLICATIONS

Housing is 22 gauge prepainted steel. Air vents surround the drivers in the back of the fixture to maximize LED and driver performance, reliability and life. High reflective enhanced white reflectors are computer designed to maximize photometric performance and put the light where you need it. Access plate in the back makes wiring fast and hassle-free. Back of fixture is designed with built-in mounting holes for tong hanger, cable kit and surface mount.



(With no lens)



(With optional wireguard)



(With frosted lens)

### ORDERING DATA

### EXAMPLE: HBPA24LED80FRDMV30

HBPA		LED		Wattage & Lumens		Lens		Driver		Color Temp	
Series	Size	Gear									
HBPA	24 23.379" 48 45.160"	LED		<b>24</b>		<b>Blank</b> No Lens	<b>DMV</b> 0-10V Dimming	<b>30</b> 3000K			
				<b>80</b> 80 Watts 10000 Lumens		<b>FR</b> Frosted	120-277VAC	<b>35</b> 3500K			
				<b>122</b> 122 Watts 15000 Lumens		<b>CL</b> Clear lens	Multivolt	<b>40</b> 4000K			
				<b>48</b>				<b>50</b> 5000K			
				<b>80</b> 80 Watts 10000 Lumens							
				<b>122</b> 122 Watts 15000 Lumens							
				<b>149</b> 149 Watts 21150 Lumens							
				<b>175</b> 175 Watts 25050 Lumens							
				<b>186</b> 186 Watts 26350 Lumens							
				<b>215</b> 215 Watts 31380 Lumens							
				<b>220</b> 220 Watts 33000 Lumens							
				<b>260</b> 260 Watts 36780 Lumens							
				<b>273</b> 273 Watts 38230 Lumens							
				<b>280</b> 280 Watts 41120 Lumens							
				<b>315</b> 315 Watts 45440 Lumens							
				<b>355</b> 355 Watts 50110 Lumens							

#### Options

<b>OS</b>	Occupancy sensor Wide angle
<b>OSD</b>	Occupancy and daylight sensor w/ dimming
<b>MP</b>	6 Ft. 3 wire
<b>EM</b>	10W 1300 lumen Battery backup
<b>CS8</b>	8' cord, no plug
<b>CS12</b>	12' cord, no plug
<b>UP45</b>	Uplight 45 system watts 4900 Lumens
<b>WG</b>	Wireguard

### ACCESSORIES

- A-HBPA24WG** Wireguard for HBPA24
- A-HBPA48WG** Wireguard for HBPA48
- AC120-Toggle-2PK** Yhook - 10' Cable Mounting Kit and 2 Spring Clips

### Note: Wire guard is optional

Dimensions and specifications subject to change without notice.



### 24L

TOP VIEW WITHOUT LENS

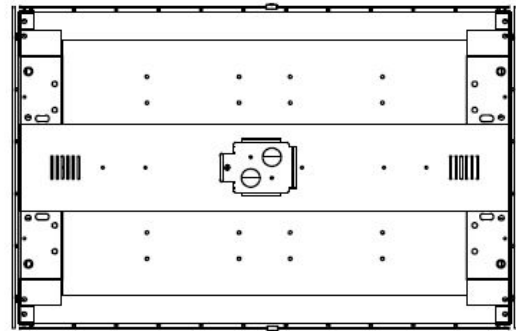
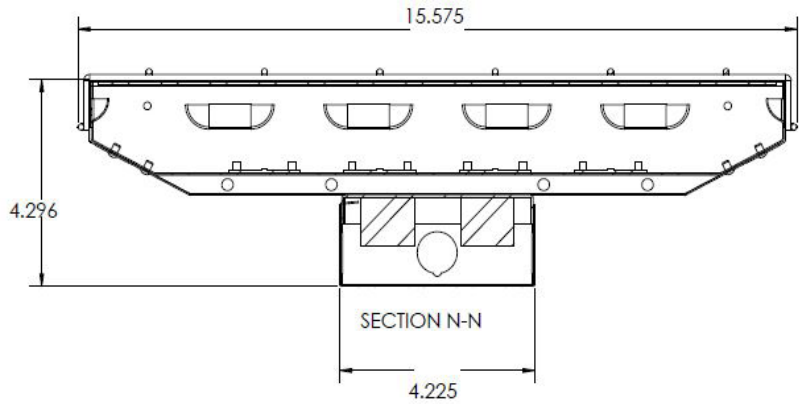
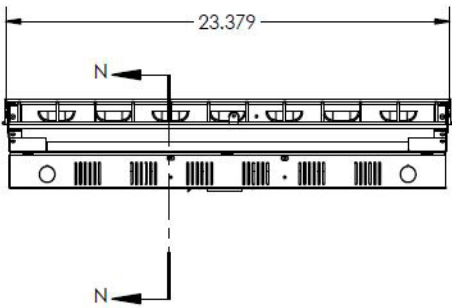
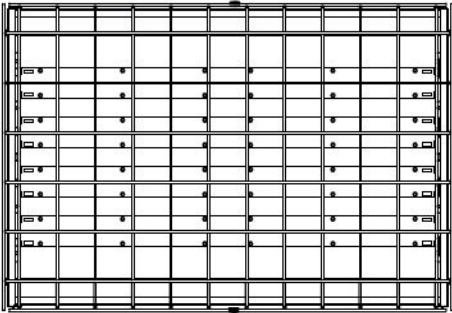

BOTTOM VIEW

### 48L

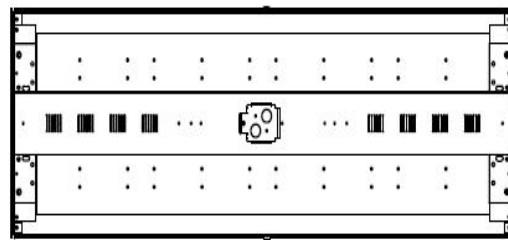
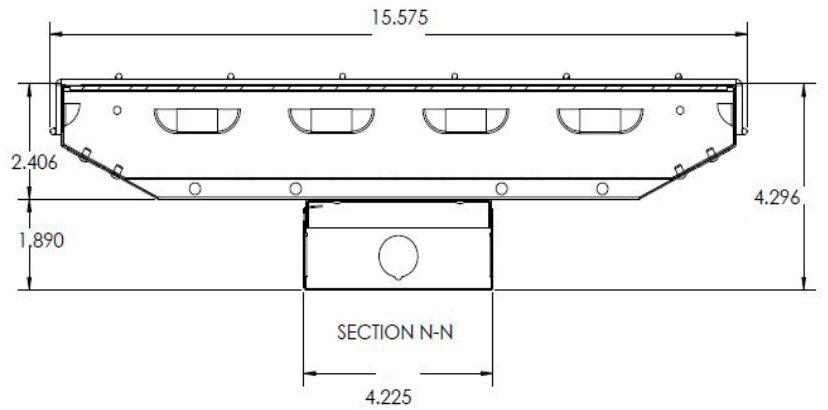
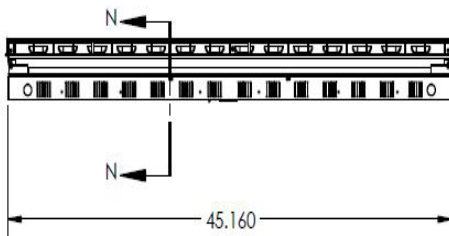
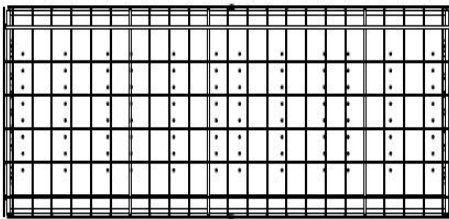

BOTTOM VIEW

Dimensions and specifications subject to change without notice.

