

### APPLICATIONS

The new Shallow Linear Linear Spread Lighting is ideal for open offices or any place where low glare, comfortable lighting is required; especially good for applications where a lot of monitors are in use. Fixtures can be individually or joined for a continuous run. The connections between the housings are made by means of a concealed locking mechanism that provides a hairline joint in continuous row applications. Shielding includes choices of perforations, slots and baffled louver for a choice of uplight and downlight effects. It has a center semi-specular baffle ora matte white lens to provide 30% downlight coupled with a choice of solid sides for more uplight or perforated sides for extra side light. This shallow body is available in 3 light T5 or 2 light T8 only. A well engineered reflector system ensures maximum efficiency over 84% and light spread.

### FEATURES & BENEFITS

- ◆ Indirect/Direct suspended lighting fixture; Indirect is 70% and direct is 30%
- ◆ The direct component is controlled by 3" wide semi-specular aluminum baffles standard or opaque overlay (by others).
- ◆ This unit is designed for two T8 lamps or up to three T5 lamps
- ◆ Fixture will also accept T8 LED tubes
- ◆ Designed for low brightness illumination without shadows for general office or classroom applications where 85 to 90% efficiency is needed. All reflectors necessary for performance are supplied as standard
- ◆ Fixture is 9 5/8" wide by 2 1/2" high
- ◆ Housing can be differentiated by specifying perforations on the bottom sides parallel to the center slot or perforations on the top sides or both. You design the look that you want to achieve.
- ◆ Fixture can be modified for LED "circuit on board" applications and will accept daylight and/or motion detectors.

### SPECIFICATIONS

The die-formed steel housing is available with open bottom for specular louver or matte white lens with riveted, heavy duty, die-cast aluminum mounting plates. Fixtures are shipped with die cast aluminum joiners for structural integrity and suspension continuity. Reflectors are enhanced aluminum for maximum efficiency for direct and indirect control. Housing and end caps are standard with out exclusive finish featuring an ultra durable white powder top coat. Custom finishes available.

**END CAPS:** Architectural ends. This die-cast aluminum end comes with a scoop styled configuration. They are bolted to the die-cast joiners for a complete architectural look.

**MOUNTING:** Fixtures are designed to mount on exact 4ft and 8ft centers. Joiners will accept stems, single cable, "V" cable and power cords as supplied by others. Mount with 5' or 15' adjustable cable (2 for 4' unit or 8' unit, included). Consult factory for longer cables.



**SIZE:** W x L x H in inches (mm)  
4ft. - 9 5/8" x 48" x 2 1/2"  
8ft. - 9 5/8" x 96" x 2 1/2"

**LAMP:**  
1, 2 or 3 lamp positions

**LISTING:**  
UL Listed

**TYPICAL OPTIONS & ACCESSORIES:**  
Emergency ballasts, LED ready or LED arrays. Contact factory for additional options.

### ORDERING DATA

EXAMPLE: CSLSMW128PFMVVWHHC301WHEM

CSLS

Series	Lamp Count	Lamp Type	Side Body	Finish	Cable Kit	Cord & Canopy Finish
CSLS	1, 2 or 3** Lamps not included	28 46" T5 32 48" T8 54 46" T5HO	blank Solid PF Perforated	WH White SL Metallic Silver RD Red IN Iron BK Black	HC301 4ft cable kit HC302 8ft cable kit	WH White BK White BKWH Black cord & White canopy BKSL Black cord & Silver canopy
<b>Center Body</b>		<b>Tandem Code</b>		<b>Ballast &amp; Voltage</b>		
MW White lens LV Baffle/blade		blank No tandem 8 8ft. tandem		MV Electronic, multivolt (120-277) HMV Electronic, multivolt Hi-lume PMV Electronic, multivolt Program Start ballast LED LED T8 Single ended LED-2E LED T8 Double ended NB No ballast or wiring		
				<b>Options</b>		
				B1 Emergency ballast 500 lumens B3 Emergency ballast 1400 lumens		

\*\* 2 light only available in T8

NOTE:

[1] Custom louvers available in any cell configuration. Consult factory for additional information

[2] HiLume and LoLume ballasts available for T8 lamps only

Dimensions and specifications subject to change without notice.



◆ 800-444-WATT ◆ www.mobern.com ◆

8200 Stayton Dr., Ste. 500, Jessup, MD 20794

CAT#

JOB NAME

TYPE

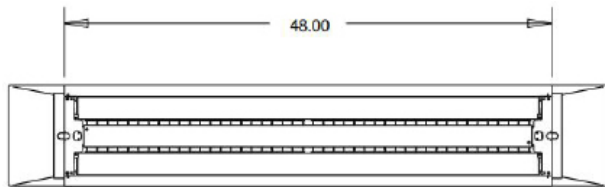
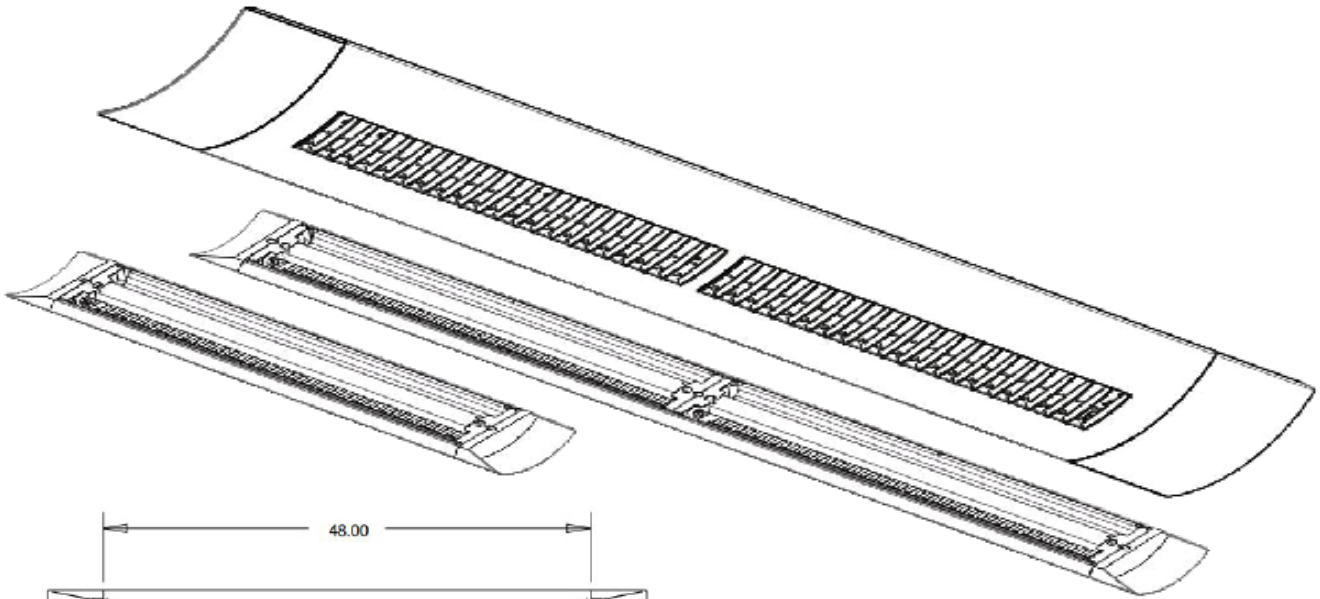

5-1/2 for Scoop End Cap

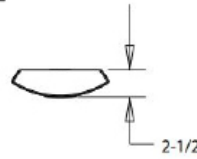
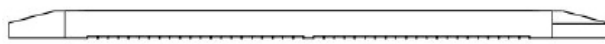

Specificati

T8	
SIZE	LENGTH
(2) 32W	48
(4) 32W	96

Add 5-1/2" for each end cap

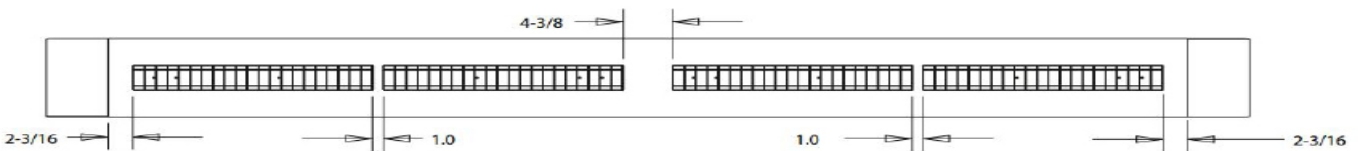
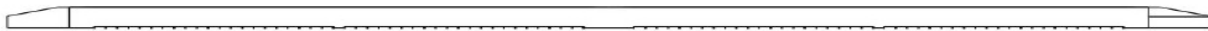
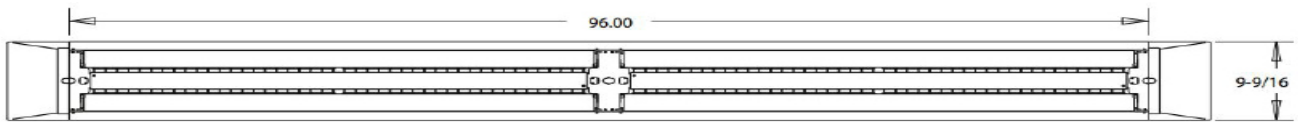
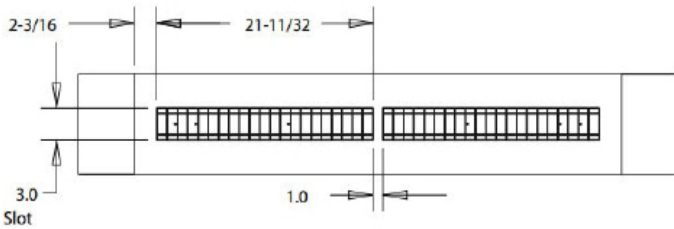

Dimensions and specifications subject to change without notice.

