

APPLICATIONS

A clear acrylic #8 pattern lens and 1 or 2 rows of LEDs in a cross-section allows this wraparound to be suitable for a variety of applications. A full wireway allows for more uniform light distribution. A great choice for corridors, hallways and other institutional spaces.

FEATURES & BENEFITS

- ◆ A full wireway allows for more uniform light distribution, 1 or 2 LEDs in cross section
- ◆ Acrylic #8 pattern lens
- ◆ Suitable for a variety of applications
- ◆ Min CRI 80
- ◆ cETL_{us} Listed for damp locations



SPECIFICATIONS

Housing is 22 gauge baked white enamel cold rolled steel body and ends. Wiring knockouts are provided on back end of housing. Ballast cover or reflector snaps into place. No tools are required for ballast access. Lens is held with lift and shift method.

ORDERING DATA

EXAMPLE: 772N-48LED28DMV40

774		LED		DMV		Options	
Series	Size	Gear LED		Driver Type	Kelvin Temperature		
5" 772N Narrow Wraparound	48 48 inch 96 96 inch		4 ft. 23 23 Watts 2650 Lumens 28 28 Watts 2950 Lumens 32 32 Watts 3450 Lumens 35 35 Watts 3800 Lumens 48 48 Watts 4800 Lumens 72 72 Watts 7200 Lumens	DMV Dimmable 120-277VAC Multivolt 0-10V SDMV Stepdimming 120-277VAC 100-40%	30 3000K 35 3500K 40 4000K 50 5000K	EM 10W, 1200 Lumen Battery backup EM7 7W 840 Lumen Battery backup EM5 5W 600 Lumen Battery backup WP 6' Whip 3 Wire	
			8 ft. 23 23 Watts 2650 Lumens 35 35 Watts 3800 Lumens 48 48 Watts 5100 Lumens 56 56 Watts 6000 Lumens 65 65 Watts 7000 Lumens 97 97 Watts 9600 Lumens	*Consult for triac dimming		Consult factory for other options	

DIMENSIONS



2 Rows of LEDs Distribution

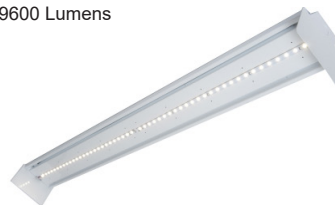

1 Row of LEDs Distribution

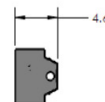
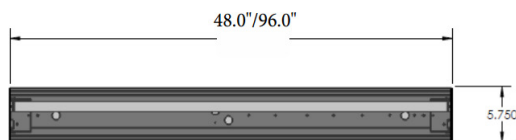

Dimensions and specifications subject to change without notice.

◆ 800-444-WATT ◆ www.mobern.com ◆
8200 Stayton Dr., Ste. 500, Jessup, MD 20794

CAT#	
JOB NAME	
TYPE	